

Community Choice Energy

IT'S ALL
ABOUT
IMPACT!



THE BUSINESS OF
LOCAL ENERGY
SYMPOSIUM



Organized by

May 5, 2017
Long Beach, CA



Local
Government
Commission

Leaders for Livable Communities



www.climateprotection.org



Local
Government
SUSTAINABLE ENERGY
Coalition

FEATURED SPEAKERS

Welcome and thank you for participating



THE BUSINESS OF LOCAL ENERGY SYMPOSIUM



Kevin de León serves as President pro Tempore of the California State Senate. He is the first Latino elected to the position in over 130 years. Senator de León is focused on building a more prosperous, equitable, and sustainable economy for the Golden State. His legislation has

created the most ambitious renewable energy goals in the nation and has required a quarter of all cap-and-trade revenue be spent in disadvantaged communities. Senator de León served four years in the Assembly before being elected to the Senate in 2010. Before the Legislature, he taught citizenship courses to immigrants.



Ben Allen was elected as California State Senator in 2014. He is a member of the Senate Committees on Elections and Constitutional Amendments, Natural Resources and Water, and Transportation and Housing. He co-chairs the Environmental Caucus. He coauthored the Senate's historic climate change legislation, SB 350. As an attorney, he worked for the law firm of Richardson & Patel LLP, and previously was a litigator with Bryan Cave LLP. Prior to his law career, he worked for the National Democratic Institute for International Affairs. He has a BA from Harvard University, a Master of Philosophy degree from the University of Cambridge, and a Juris Doctorate from UC Berkeley.

As an attorney, he worked for the law firm of Richardson & Patel LLP, and previously was a litigator with Bryan Cave LLP. Prior to his law career, he worked for the National Democratic Institute for International Affairs. He has a BA from Harvard University, a Master of Philosophy degree from the University of Cambridge, and a Juris Doctorate from UC Berkeley.



Michael Picker was named President of the California Public Utilities Commission (CPUC) on December 23, 2014. Prior to his appointment, President Picker was Senior Advisor for Renewable Energy in the Office of the Governor from 2009 to 2014. He was a principal at Lincoln

Crow Strategic Communications from 2000 to 2009, Deputy Treasurer in the Office of the California State Treasurer from 1998 to 1999, Chief of Staff to Sacramento Mayor Joe Serna Jr. from 1992 to 1999, and Deputy Assistant for toxic substance control in the Office of the Governor from 1981 to 1982. He holds an MBA from UC Davis, specializing in marketing, social marketing, and nonprofit management.



Geof Syphers is the Chief Executive Officer of Sonoma Clean Power, a position he has held since the program's inception in 2013. Under his leadership, SCP now serves 450,000 people throughout Sonoma County with cleaner power at competitive rates. Prior to his current position,

Geof worked for 20 years as an energy consultant to utilities, public agencies and private companies. His work has spanned microgrid design, zero-carbon community design and energy efficiency program implementation. He served as the Chief Sustainability Officer for Coddling Enterprises and was the founding Director of DNV's Green Building Group.



Dawn Weisz is the CEO for MCE Clean Energy and she coordinated efforts to explore, develop and launch MCE as the first Community Choice Aggregation program in California. Dawn has 20 years of experience developing and managing renewable energy and energy efficiency

programs and projects while working for leading public agencies in the field. Previously, she was a Principal with the County of Marin, where she managed energy and sustainability initiatives and served as the Executive Director for Sustainable North Bay. Dawn has also received awards from the US Environmental Protection Agency, the US Department of Energy, and the Power Association of Northern California.



Barbara Hale is the Assistant General Manager responsible for the San Francisco PUC's Power functions. That includes San Francisco's Municipal Power Utility, serving 2,300 accounts with an average demand of 150 MW, and CleanPowerSF, San Francisco's Community Choice program.

CleanPowerSF has been operating since May and is currently serving 73,000 accounts with an average demand of 55 MW. Prior to her employment with SFPUC, Barbara worked for the State of California PUC in progressively responsible positions, including Advisor to President, Administrative Law Judge, and Director of Strategic Planning.

FEATURED SPEAKERS



Jason Caudle became Lancaster's Deputy City Manager in 2008. He has been integral in developing and implementing multi-scaled sustainable energy projects, as well as Lancaster's award-winning downtown district, "The BLVD." Jason has overseen formation of the Lancaster Power Authority, California Clean Energy Authority, and Lancaster Choice Energy - the City's Community Choice Aggregate. Previously, he was Vice President of Public Finance for Kinsell, Newcomb & De Dios, as well as City Manager of Tehachapi. Jason holds a Bachelor's degree in Political Science and Master's degree in Public Policy and Administration, both from California State University Bakersfield.



Jan Pepper, the Chief Executive Officer of Peninsula Clean Energy, has over 30 years of energy and utility experience and was the founder of four energy-related start-ups. She developed and pioneered the first use of renewable energy credits, which are now the standard currency for trading and tracking renewable power. She earned a BS in civil engineering and an MBA, both from Stanford University. Jan is a registered professional engineer in California.



Dr. Robert Garcia is an educator and the 28th Mayor of Long Beach. Mayor Garcia has taken a leadership role in economic development, sustainability, and investing in technology. He is committed to moving Long Beach forward by attracting tech and green jobs, creating new educational partnerships, and making government more efficient. He holds a Master's Degree from University of Southern California and a Doctorate in Higher Education from Cal State Long Beach, where he also earned his Bachelor's in Communication.



Dr. Lorenzo Kristov is a Principal in Market and Infrastructure Policy at the California Independent System Operator (ISO). His primary focus at present is to facilitate the transformation of the electric system from a central-station, fossil-fueled industry to a more decentralized, renewable-energy system. In his 18 years at the ISO he has led many complex stakeholder initiatives, including comprehensive redesign of California's power markets and enhancements to markets and infrastructure planning procedures to integrate renewable and distributed generating resources, storage, and aggregations of small distributed resources



Obadiah Bartholomy is a Senior Manager of Distributed Energy Resources group at SMUD. Obadiah also manages several solar related projects including solar forecasting and variability assessment, and high penetration PV evaluation and mitigation. He earned a BS in mechanical engineering from Cal Poly, San Luis Obispo, and an MS in transportation technology and policy from UC Davis.



Beth Reid is founder and CEO of Olivine. She is a proven leader helping clients navigate the complexities of integrating distributed energy resources with the grid to provide renewable energy resources to future generations. Olivine advocates simplifying the ecosystem to enable new business models and innovative technologies.



Laura Manz, the Director of Navigant, brings over 30 years in the energy industry with management and field experience in grid operations and planning, regulatory policy, power plant operations and interconnection, distributed energy, and advanced technology. She worked for the California Independent System Operator as Vice President - Market and Infrastructure Development with responsibility for grid planning and interconnections, market design, regulatory policy, and NERC compliance. She performed a Nodal Market Risk Assessment for ERCOT in Texas to support their conversion to a location-based marginal pricing model.



Jeff Byron has 40 years of experience in emerging energy technologies, customer requirements, and energy policy. He is a member of the Band of Angels, was a Fellow in the inaugural cohort at the Stanford Distinguished Career Institute in 2015, and was a California Energy Commissioner from 2005 to 2011.



Rick Brown, PhD launched TerraVerde Renewable Partners, an energy and solar advisory firm, in 2009. Over the past seven years the TerraVerde team has developed \$327 million of distributed energy resources (DER), including 70 MWs of solar, 13 MWs storage and energy conservation measures in over 300 buildings on behalf of schools, cities, transit agencies and water districts. Using these assets, TerraVerde is now developing programs that will create new revenue streams and reduce power and resource adequacy costs for Load Serving Entities through deployment of DER/non-wire strategies.

AGENDA

7:30 - 8:30 am

REGISTRATION AND BREAKFAST

Regency Foyer

8:30 - 8:40

INTRODUCTION

Regency Ballroom (ABCH)

Ann Hancock

Executive Director, Center for Climate Protection

8:40 - 8:50

WELCOME TO LONG BEACH

Regency Ballroom (ABCH)

Mayor Robert Garcia

City of Long Beach

8:50 - 9:00

COMMUNITY CHOICE: A STATE PERSPECTIVE

Regency Ballroom (ABCH)

Senator Ben Allen

California State Senate

9:00 - 10:05

PLENARY PANEL: COMMUNITY CHOICE, GROWING IN A DYNAMIC ENVIRONMENT.

Regency Ballroom (ABCH)

A conversation about the future of California's energy system.

Jeff Byron (Moderator)

Former Commissioner, California Energy Commission

Michael Picker

President, California Public Utilities Commission

Geof Syphers

Chief Executive Officer, Sonoma Clean Power

Underwritten by Bay Area Air Quality Management District

Introduced by Marcie Milner, Vice President, Regulatory Affairs, Shell Energy North America

10:05 - 10:30

NETWORKING BREAK

Regency Foyer

10:30 - 11:45

BREAKOUT PANELS

THE BASICS OF STARTING A COMMUNITY CHOICE ENERGY PROGRAM

Beacon Ballroom

PROGRAMS THAT CREATE VALUE FOR CUSTOMERS

Seaview Ballroom

CCE 3.0 - INTEGRATED DER NIRVANA

Regency DE

CCE ENERGY ECOSYSTEM: OPPORTUNITIES AND CHALLENGES

Regency F

INNOVATIVE PARTNERSHIPS: BIG IDEAS TO OPTIMIZE CCE IMPACT

Shoreline AB

12:00 - 12:40

LUNCH

Regency Ballroom (ABCH)

Underwritten by The County of Los Angeles

12:40 - 12:55

RECOGNIZING EARLY COMMUNITY CHOICE HEROES

Regency Ballroom (ABCH)

We acknowledge those who began with little more than a dream and kept working to make Community Choice a reality.

12:55 - 1:25

KEYNOTE ADDRESS

Regency Ballroom (ABCH)

Senator Kevin de León

President Pro Tempore, California State Senate

Introduced by Alex Makler, Senior Vice President, Calpine Corporation

1:25 - 1:40

NETWORKING BREAK

1:40 - 2:40

BREAKOUT PANELS

ENERGY DEMOCRACY: ENGAGING ALL STAKEHOLDERS

Shoreline AB

PREPARING FOR LIFT-OFF IN SOUTHERN CALIFORNIA

Seaview Ballroom

FINANCING: FROM START-UP TO PROGRAM

Regency F

OPERATIONAL EFFICIENCY, BALANCING PRIORITIES AND STAYING OUT OF TROUBLE

Regency DE

STATE LEGISLATIVE AND REGULATORY OPPORTUNITIES AND THREATS

Beacon Ballroom

2:40 - 3:00

NETWORKING BREAK

Regency Foyer

Snacks underwritten by Green Cities California

3:00 - 3:55

PLENARY PANEL: UNLOCKING THE PROMISES OF DISTRIBUTED ENERGY RESOURCES

Regency Ballroom (ABCH)

Experts discuss the challenges and opportunities for CCEs in accelerating deployment of local resources.

Rick Brown (Moderator)

President and Board Chairman, TerraVerde Renewable Partners

Obadiah Bartholomy

Manager, Distributed Energy Resources, Sacramento Municipal Utility District

Beth Reid

CEO, Olivine

Lorenzo Kristov

Principal, Market & Infrastructure Policy, California Independent System Operator

Laura Manz

Director, Navigant

Underwritten by Direct Energy

3:55 - 4:55

PLENARY PANEL: CALIFORNIA COMMUNITY CHOICE LEADERS - LESSONS LEARNED

Regency Ballroom (ABCH)

Four of the leaders of operating CCEs address the state of the movement and what is working in their service territories.

Ann Hancock (Moderator)

Executive Director, Center for Climate Protection

Dawn Weisz

Chief Executive Officer, MCE Clean Energy

Jason Caudle

Deputy City Manager, City of Lancaster

Barbara Hale

Assistant General Manager, CleanPowerSF

Jan Pepper

Chief Executive Officer, Peninsula Clean Energy

Underwritten by Constellation Energy

Introduced by Geof Syphers, Chief Executive Officer, Sonoma Clean Power

4:55 - 5:00

CLOSING REMARKS

Regency Ballroom (ABCH)

5:00 - 6:30

NETWORKING RECEPTION

Regency Foyer

Underwritten by EES Consulting

See map on page 19 for room locations.

**MORNING
BREAKOUT
SESSIONS
10:30 - 11:45 AM**

**The Basics of Starting a
Community Choice Energy
Program**

CM 1.25

Location: Beacon Ballroom

Local government elected and staff leaders describe the reasons for their community's support for CCE, their experience of the process, and share lessons-learned relevant to any other local government. Issues covered will include: key steps in the process, community outreach and education, technical studies, building political support, staff capacity, financing, and structuring energy portfolios and rates based on community priorities.

PANELISTS:

Moderator: **Margaret Bruce**, Local Government Sustainable Energy Coalition Program Manager, Local Government Commission

Steve Shupe, Counsel, Sonoma Clean Power

Supervisor Dave Pine, County of San Mateo

Gine Johnson, Supervisor's Analyst, Office of County Supervisor Bruce McPherson

Anne Falcon, Senior Associate, EES Consulting

**Programs that Create Value
for Customers**

CM 1.25

Location: Seaview Ballroom

Professionals and commercial operators with hands-on experience, working on programs for the three longest operating CCEs—MCE Clean Energy, Sonoma Clean Power and Lancaster Choice Energy—will talk about best practices. Specific programs discussed will include energy efficiency, demand response, electric vehicles, Feed in Tariff, and other distributed energy resource projects.

PANELISTS:

Moderator: **Kelly Knutsen**, Senior Policy Advisor, California Solar Energy Industries Association

Beckie Menten, Director of Customer Programs, MCE Clean Energy

Alan White, Chief Business Officer, eMotorWerks

Jason Caudle, Deputy City Manager, City of Lancaster

CCE 3.0, Integrated DER Nirvana

CM 1.25

Location: Regency DE

Industry experts will focus on what CCEs have done so far to integrate distributed energy resources (DER) into their service territories, what is happening in other parts of the country, and what the most promising future opportunities are. What are the challenges to DER expansion and what benefits will it provide to CCEs, customers, and the grid? Can we get to the nirvana of a 100% renewable portfolio with a significant percentage of local resources integrated at an affordable cost?

PANELISTS:

Moderator: **Gerry Braun**, Director, Integrated Resources Enabling Sustainability Network

Dan Kalb, Councilmember, City of Oakland

Greg Thomson, Vice President of Program Development, Pathion

Paul Fenn, Chief Executive Officer, Local Power Inc.

Gary Stern, Senior Director of Energy Policy, Southern California Edison

CCE Energy Ecosystem: Opportunities and Challenges

CM 1.25

Location: Regency F

There are many players in the California energy landscape: public agencies, electric service providers, municipal utilities, regulatory agencies, consultants, and private developers. Members of these groups speak about opportunities for CCEs and potential challenges as they increase their market share in the coming years.

PANELISTS:

Moderator: **Julia Pyper**, Senior Editor, Greentech Media

Will Mitchell, Director of Government Affairs, Recurrent Energy

Ted Beatty, Director of Resource and Program Development, Southern California Public Power Authority

David Erickson, Head of Section, Distributed Energy Resources, DNV GL

Innovative Partnerships: Big Ideas to Optimize CCE Impact

CM 1.25

Location: Shoreline AB

A panel of private parties with innovative ideas for how CCEs could partner, create new local programs and achieve at least one of the following three goals: 1) Better service to customers, 2) Lower costs of operation or service, 3) Greenhouse gas emissions reductions. Some of the ideas presented may do all three. The panelists will discuss fuel switching for hot water heating, financing for energy efficiency and demand response measures, and electric vehicle deployment.

PANELISTS:

Moderator: **Angelina Galiteva**, Board Member, California Independent System Operator

Mark Higgins, Chief Operating Officer, Strategen Consulting

Dennis Quinn, Chief Operating Officer, Joule Assets

Gary Klein, President, Gary Klein & Associates

NOTE: In this program we use the abbreviation "CCE" for Community Choice Energy. CCE refers to the same policy known in the California Public Utilities Code as Community Choice Aggregation, or CCA.

**AFTERNOON
BREAKOUT
SESSIONS
1:40 - 2:40 PM**

**Energy Democracy –
Engaging All Stakeholders**

CM 1.25

Location: Shoreline AB

Representatives from the environmental justice and labor communities will discuss how to ensure that CCEs serve all their customers. How do we organize to initiate CCEs so that they maximize community benefits such as job creation and community health? What does organized labor think of CCEs and what are their concerns? How do we hold operational CCEs accountable to their customers and the community as a whole?

PANELISTS:

Moderator: **Dolores Weller**, Director, Central Valley Air Quality Coalition

Dr. Gisele Fong, End Oil, Executive Director, Clean Our Ports

Joe Galliani, Chair, South Bay Clean Power

Jessica Tovar, Organizer, Local Clean Energy Alliance

Jennifer Kropke, Director of Workforce and Environmental Engagement, IBEW 11

**Preparing for Lift-Off in
Southern California**

CM 1.25

Location: Seaview Ballroom

Local government leaders share their updates on the vision and the progress of launching CCEs in various regions in Southern California. Panelists will share the unique circumstances, priorities, challenges and goals of their diverse communities.

PANELISTS:

Moderator: **Howard Choy**, (retired) General Manager, Office of Sustainability for the County of Los Angeles

Jennifer Cregar, Project Supervisor, Energy and Sustainability, County of Santa Barbara

Gary Gero, Chief Sustainability Officer, County of Los Angeles

Jack Clark, Deputy Director, Environmental Services Department, Energy and Sustainability Division, County of San Diego

Financing: From Startup to Program

CM 1.25

Location: Regency F

Hear from financial professionals who understand the unique positions of CCEs in the market. Learn how millions of dollars in working capital financing was successfully provided for currently operating CCEs. The panel will also discuss the real obstacles that CCEs face with program and project financing and how to overcome them.

PANELISTS:

Moderator: **Seth Baruch**, President, Carbonomics

Ian Parker, Managing Director, Public Sector and Infrastructure Banking, Goldman Sachs

Steve Fleming, President and Chief Executive Officer, RiverCity Bank

Jeff Waller, Principal, Rocky Mountain Institute

Operational Efficiency, Balancing Priorities, and Staying Out of Trouble

CM 1.25

Location: Regency DE

Energy program regulatory compliance experts, including those serving in established CCE programs, will provide practical information for CCE implementers including: comparing and contrasting the current governance structure options for CCEs, balancing financial and program objectives, and meeting current and future regulatory requirements.

PANELISTS:

Moderator: **Shawn Marshall**, Founder, Chief Executive Officer, Local Energy Aggregation Network

Kirby Dusel, Vice President, Pacific Energy Advisors

Jan Pepper, Chief Executive Officer, Peninsula Clean Energy

Geof Syphers, Chief Executive Officer, Sonoma Clean Power

State Legislative and Regulatory Opportunities and Threats

CM 1.25

Location: Beacon Ballroom

Legislative and regulatory staff from operating CCEs present the critical issues to watch in 2017 and beyond. Concerns include the Power Charge Indifference Adjustment (PCIA), SB 618, AB1110 regulatory proceedings, Distributed Energy Resource Plans, the Transmission Access Charge, and more. The discussion will focus on better understanding these issues and how we organize to ensure that CCE interests are adequately represented and defended. What policies will CCE's need to support their growth and service over the next five to ten years?

PANELISTS:

Moderator: **Joe Como**, Former Director, Division of Ratepayer Advocates

Barbara Hale, Assistant General Manager, CleanPower SF

Neal Reardon, Regulatory Affairs Manager, Sonoma Clean Power

Shalini Swaroop, Deputy General Counsel, MCE Clean Energy

SPEAKER PROFILES



Seth Baruch is an internationally recognized expert in the development of methodologies to monitor greenhouse gas (GHG) reductions. Seth was co-founder and managing partner for QualityTons, a consulting company that developed and implemented numerous GHG-mitigation projects around the world. Now at Carbonomics, Seth continues to develop projects under California's cap and trade program. He is also very involved in promoting Community Choice in Alameda and Contra Costa counties. He co-authored an extensive analysis on the financial, environmental and employment impacts of a potential Community Choice program in the East Bay, which has been distributed to officials and other stakeholders across both counties.



Ted Beatty has been the Director of Resource and Program Development at the Southern California Public Power Authority (SCPPA) since October 2014, where he manages joint action for 12 member public utilities through a broad range of services including power supply, transmission, energy efficiency and demand side management. Prior to arriving at SCPPA, Ted held various positions at Energy Northwest, Tacoma Power, Dynegy Inc. and the US Navy Nuclear Submarine Force. He has a Bachelor of Science degree in Mechanical Engineering from Carnegie Mellon University and a Master of Business Administration specializing in Energy Finance from the University of Texas.



Gerry Braun is an energy industry veteran and clean energy pioneer, having initiated and managed clean energy R&D programs for two major California utilities, the US Department of Energy and the California Energy Commission. He is founder and chair of the Integrated Resources Network, Chair of the City of Davis Utility Rate Advisory Committee and a member of the Valley Clean Energy Alliance Advisory Committee. He holds mechanical and nuclear engineering degrees from the University of Michigan and the Massachusetts Institute of Technology.



Margaret Bruce is the Program Manager for the Local Government Commission's Local Government Sustainable Energy Coalition. Margaret also has her own energy and sustainability consulting practice and serves on the SLV Water District Board. Margaret's career encompasses environmental, energy and sustainability fields, from start-up to program management in non-profits, federal and state government and the private sector.



Howard Choy, recently retired from being General Manager of the Office of Sustainability in Los Angeles County, develops and manages energy and environmental programs for municipal operations and in the Los Angeles County region. During his time with LA County he initiated their PACE programs, the Southern California regional energy network and LA's CCA effort.



Jack Clark is the Deputy Director of the Energy & Sustainability Division at the City of San Diego. Jack has more than 20 years of experience in energy, environmental and cultural programming directed solely at developing comprehensive and inclusive solutions to climate change. He oversees the City operations energy use, billing, rates, Municipal Energy Plan, community energy and sustainability programs, and compliance with the City Climate Action Plan. Prior to joining the City of San Diego, Jack was the Director of Programs at the Center for Sustainable Energy.



Joe Como has been an attorney and utility customer advocate for 17 years. He was an early advocate for Community Choice Energy with the City of San Francisco, former director of the Office of Ratepayer Advocates, and current advisor to the Center for Climate Protection.



Jennifer Cregar is leading the community choice energy evaluation for the County of Santa Barbara, working with local governments and community stakeholders throughout San Luis Obispo, Santa Barbara, and Ventura counties. She has 15 years of experience championing and implementing sustainable energy use and resource conservation practices.



Kirby Dusel is Vice President and co-founder of Pacific Energy Advisors, Inc., which provides strategic advice and technical support to organizations within California's energy market. He has served many public agencies within California and throughout the U.S. during his 18 year career in the electric utility industry. He is currently a lead technical advisor to the following CCE programs: Marin Clean Energy, Lancaster Choice Energy, CleanPowerSF, Peninsula Clean Energy, Silicon Valley Clean Energy, and Apple Valley Choice Energy, as well as several other communities considering CCE formation.



Dave Erickson is Head of Section for the DER group at DNV GL, a global consulting firm. His team leads consulting engagements on energy storage, micro-grids, and evaluation of the economics and technical impacts of intermittent and distributed renewables on the grid. Since joining DNV GL in 2016, Dave has led client engagements on distributed energy strategy, electricity storage, wholesale market analysis and modeling.

SPEAKER PROFILES



Anne Falcon manages EES Consulting's Management Services group including providing project management and technical support for all types of economic and financial studies. She has over 20 years of experience managing projects concerning cost-of-service and rate analyses, resource planning, asset valuations, demand-side management, financial planning, and regulatory proceedings for electric, water, wastewater, and natural gas utilities. Her areas of expertise include restructuring, strategic planning, forecasting, unbundled cost-of-service studies, optimization research and specialized statistical studies. She has a BS in Economics from the University of San Francisco and an MS from Stanford in Operations Research.



Paul Fenn wrote California's CCA law after co-authoring the nation's landmark CCA legislation in Massachusetts in 1994. Fenn was a leading intervenor in the CPUC's CCA proceeding, and has led the development of "CCA 2.0" as a participant in the Marin, Sonoma, and San Francisco CCA formations, since developing the nation's landmark "solar bond" authority to finance Distributed Energy Resources in 2001.



Steve Fleming has been President & Chief Executive Officer of River City Bank since September 2008. Under his leadership the Bank has more than doubled in size from \$800 million to \$1.8 billion in total assets and is now the largest and most profitable bank based in Sacramento. He has over 35 years of banking experience, including over 20 years with Bank of America in Sacramento and London, England. Steve received a BA in Economics from the University of California at Davis and an MBA at the University of California at Berkeley.



Gisele L. Fong, Ph.D. is Executive Director of EndOil / Communities for Clean Ports, an environmental health community-based, non-profit agency in Long Beach, California. Gisele is chair of the Environmental Health Work Group of Building Healthy Communities: Long Beach, a collaborative initiative to reduce health disparities and improve community health through systemic changes fueled by adult and youth resident engagement. Gisele is an appointee on the California Air Resources Board's Environmental Justice Advisory Committee to advise on the State of California's plans to reduce its greenhouse gases.



Angelina Galiteva has served two terms on the California Independent System Operator Corporation Board of Governors. Angelina is currently President for NEOptions, Inc., a renewable energy and new technology product design and project development firm. Her industry experience includes serving as Executive Director of the Los Angeles Department of Water and Power and head of its Green LA, Environmental Affairs and New Product Development Organization. She graduated from Pace University School of Law with a Juris Doctor degree in 1993 and an LL.M. degree in 1994 in Environmental and Energy Law.



Joe Galliani has been Chair of the South Bay Clean Power Working Group since 2014, where he works to bring CCA to 20 cities of the South Bay and West Side of Los Angeles County. In 2015 Joe successfully secured feasibility study funding from the L.A. County Board of Supervisors.



Gary Gero was recently appointed to be the first Chief Sustainability Officer for the County of Los Angeles, where his duties include creating a countywide sustainability plan that addresses regional environmental, economic, and social justice issues.

Gary served for the past nine years as the President of the Climate Action Reserve, a nonprofit organization headquartered in Los Angeles and operating across North America. Gary's career includes nearly 20 years of work in local government, primarily in the City of Los Angeles.



Ann Hancock is co-founder and Executive Director of the Center for Climate Protection and she oversees Clean Power Exchange. With more than 25 years in community leadership, education and fundraising, she has been a sustainability planner for the County of Marin, commentator for TomPaine.com, human sexuality instructor at Humboldt State University, and real estate broker. She has a Masters in Public Health Administration and Planning from the University of California, Berkeley.



Mark Higgins has worked in a diverse range of roles within the energy industry. Mark is the COO of Strategen Consulting and leads the company's consulting practice. Prior to Strategen, Mark led PG&E's work in key policy areas including interconnection and transmission planning, and dealt with technologies ranging from distributed energy storage and demand response to large scale renewables developments.



Gine Johnson has been leading the effort with Santa Cruz County Supervisor Bruce McPherson to form Monterey Bay Community Power, a 21-member, tri-county CCE agency that will launch in the spring of 2018. She brings 41 years of private and public sector experience to this effort.

SPEAKER PROFILES



Dan Kalb, an Oakland City Councilmember, was first elected in 2012. Among his accomplishments, he authored the ordinance to ban the storage and handling of coal in Oakland. Dan also serves as vice-chair of the newly formed East Bay Community Energy (EBCE) joint powers authority. From 2003-2012, Dan was California Policy Director with the Union of Concerned Scientists, where he took a lead role in the coalition that passed legislation requiring that one-third of California's electricity come from renewable sources by the end of this decade.



Gary Klein, President of Gary Klein & Associates, Inc. has been intimately involved in energy efficiency and renewable energy since 1974. After serving 19 years with the California Energy Commission, he has provided consulting on sustainability since 2008, with an emphasis on the water-energy-carbon connection.



Kelly Knutsen serves as the Senior Policy Advisor for the California Solar Energy Industries Association (CALSEIA), working on solar deployment policies on the state and local level. Previously, Kelly worked at the Department of Energy's Office of Energy Efficiency and Renewable Energy and the Solar Program. He also served as energy and environment advisor for Senator Jack Reed (D-RI) and Senator Mark Udall (D-CO). Kelly developed state and local policy experience with Utah Clean Energy and renewable energy technical expertise as a post-doc at the National Renewable Energy Laboratory.



Jennifer Kropke graduated from UCLA's School of Law. She began her legal career at a large, multinational firm in Manhattan, and realized that she was eager to work in public interest law. She then became an attorney for the City of New York, litigating child welfare abuse and neglect cases. Jennifer moved back to California and opened her own law firm representing children with learning and other disabilities. She now works as the Director of Workforce and Environmental Engagement at the International Brotherhood of Electrical Workers. In this capacity, Jennifer is focused on economic and workforce development that pays family-sustaining wages in the renewable energy arena, including CCA.



Shawn Marshall is the founder and Executive Director of LEAN Energy US (Local Energy Aggregation Network), a non-profit and consulting organization that exists to support the expansion of clean energy community choice aggregation (CCA). In 2007, Shawn served on the task force that ultimately became the Marin Energy Authority (MEA), a joint powers agency that runs the first CCA in California and the first clean energy CCA in the country. In addition to her work in the CCA field, Shawn served two terms on the Mill Valley City Council, as Mayor in 2008 and Vice Mayor in 2013.



Beckie Menten is the Customer Programs Director at MCE Clean Energy, where she oversees the design and deployment of demand side management programs. She has an extensive background in both energy efficiency and local government, having worked at the city, county, and state level to design efficiency programs. Prior to MCE, Beckie was most recently the Program Manager for the Energy Efficiency in Existing Buildings program at the California Energy Commission. Beckie also worked with the Demand Side Management group of the California Public Utilities Commission. Beckie has a Master of Science degree in Environmental Systems from Humboldt State University.



Will Mitchell is a Director of Government Affairs at Recurrent Energy, a leading U.S. solar project developer. Will oversees Recurrent Energy's legislative and regulatory affairs agenda across the western United States. Prior to joining Recurrent Energy, he spent six years with Competitive Power Ventures (CPV), a leading North American independent power producer, where he drove external affairs activities across a multi-state 15 GW portfolio of combined and simple-cycle natural gas, wind, and solar energy facilities. Will holds a BA from Roger Williams University in Bristol, Rhode Island.



Ian Parker is a member of the Public Sector and Infrastructure Banking team at Goldman Sachs, focusing on municipal clients located throughout the western region of the United States. In his current role, he works with clients in the transportation, water and general government space. Ian has led the execution of over \$20 billion of long-term debt and \$8 billion of short-term debt financings as a senior or joint lead underwriter since he joined Goldman Sachs in 2008 as a vice president. He was named managing director in 2010. Ian earned a BA, with honors, from Harvard College in 1989.



Dave Pine was first elected to the San Mateo County Board of Supervisors in May 2011, and was a champion of Community Choice Energy. San Mateo launched their program faster than any previous community and with unanimous votes in all 20 participating cities. Supervisor Pine currently serves on Peninsula Clean Energy's Board of Directors. Before his career in public service, he worked as an attorney representing start-up and high-growth technology companies. He is a graduate of Dartmouth College and the University of Michigan Law School.

SPEAKER PROFILES



Julia Pyper is a Senior Editor at Greentech Media covering clean energy policy, the solar industry, grid edge technologies and electric mobility. She previously reported for E&E Publishing in Washington D.C. Her work has been published in Scientific American and The New York Times. Julia has covered clean energy and climate change issues across the U.S. and abroad, including in Haiti, Israel and the Maldives. She holds degrees from McGill and Columbia universities.



Dennis Quinn is an industry pioneer with more than two decades of experience and success with energy efficiency and conservation. Before co-founding Joule Assets and JouleSmart Solutions, he was a founding member and CEO of Celerity Energy, LLC, one of the first demand response companies in the United States.



Neal Reardon serves as Regulatory Affairs Manager at Sonoma Clean Power. He is responsible for representing and advocating for SCP's interests in addition to assisting with compliance obligations and legislative efforts. Neal has over ten years of experience in the energy industry and has worked for a variety of financial institutions and consulting groups. Prior to his current role, he was a Senior Analyst with the California Public Utilities Commission (CPUC). Neal holds an MBA from the Fisher Graduate School of International Business and a Master's degree in Environmental Policy from the Middlebury Institute of International Studies.



Steve Shupe is General Counsel for Sonoma Clean Power. He has over 30 years of experience as an attorney, and for 16 years served as a Deputy County Counsel for the County of Sonoma, primarily representing the Sonoma County Water Agency in water, energy, and environmental matters. Steve was an original member of the Water Agency team that investigated the feasibility of forming Sonoma Clean Power. As SCP's General Counsel he also has been involved in key regulatory issues at the CPUC that affect Community Choice Aggregation entities.



Gary Stern is currently Senior Director of Energy Policy in the Regulatory Affairs Organization at Southern California Edison. He has held various positions at SCE since 1984 in planning, finance, electricity market, and regulatory areas and holds a PhD in Economics from UC San Diego.



Shalini Swaroop leads MCE Clean Energy's legislative program and has advocated in over 50 regulatory proceedings. She directed MCE's efforts to defeat AB 2145 (2014) and negotiated CCA amendments in SB 350 (2015). Her policy advocacy focuses on cost allocation, jurisdiction, fair competition, program implementation challenges, and equity issues in disadvantaged communities.



Greg Thomson is currently Vice President, Program Development at PATHION, Inc. PATHION's integrated technologies and services deliver safe, affordable, and smart energy systems, making it easy and cost-effective for communities, property owners and grid operators to achieve their energy goals. Greg designs and deploys programs that optimize local energy solutions and financial outcomes by integrating renewable generation, energy storage, and other Distributed Energy Resources (DER) across geographic areas and service territories. Greg recently co-authored two winning California Energy Commission grant proposals which will serve as models for deploying community-based renewable energy.



Jessica Tovar is a staff organizer for the Local Clean Energy Alliance. After growing up in East Los Angeles, Jessica worked for over a decade as an environmental justice organizer in a variety of urban, rural, and indigenous communities throughout California and Arizona. In the Bay Area she successfully mobilized against expansion of the Chevron Richmond oil refinery. She currently organizes for clean energy solutions and has won a commitment to local clean energy development through Alameda County's East Bay Community Energy program.



Jeff Waller is a Principal with Rocky Mountain Institute's Sustainable Finance practice. He works closely with RMI's major practice areas to ensure that the application of finance to RMI's research and programs is as rigorous and innovative as possible. Prior to RMI, Jeff spent 13 years as a project finance banker, structuring loans that financed utility-scale renewables.



Dolores Weller leads a 70+ member organization coalition committed to improving air quality in the San Joaquin Valley. Knowledgeable about air pollution and its impacts, she's an advocate for public health, prioritizing environmental justice communities. Dolores served as a strategic advisor to the Clean Power Exchange project in 2016, helping to introduce Community Choice Energy to Central Valley community leaders. She earned her BA in Comparative Politics from the University of California, San Diego.



Alan White is the Chief Business Officer for eMotorWerks, and has held executive positions for technology companies developing energy, industrial, simulation, and supply-chain solutions. Alan has developed patents for software to connect distributed energy resources to the smart grid. His experience includes energy trading, and positions at Silicon Graphics and Autodesk. Alan was co-founder of SupplyBase (i2 Tech acquisition), established Daintree Networks lighting controls business (GE acquisition), and managed market development for ChargePoint. He holds a BS in Applied Mathematics and Economics from Union College, and an MS in Operations from the MIT Sloan School.

People. Power. A Clean Energy Future.

center for
climate
protection



Deputy Director Barry Vesser, Center for Climate Protection, (left) addresses the California Public Utilities Commission, April 6, 2017, Santa Rosa.

OPERATING COMMUNITY CHOICE ENERGY PROGRAMS:

2010 MCE

2016 CleanPowerSF

2017 Silicon Valley Clean Energy

2014 Sonoma Clean Power

2016 Peninsula Clean Energy

2017 Redwood Coast Energy Authority

2015 Lancaster Choice Energy

2017 Apple Valley Choice Energy



Ann Hancock

Executive Director,
Center for Climate Protection

It's all about impact

Recognizing the power of Community Choice Energy, the Center for Climate Protection began advocating for it in 2005. What a long way we've come!

At the 2016 Business of Local Energy symposium, we projected that about 60 percent of eligible Californians would be served by Community Choice by 2020. For this year's symposium, we've calculated CCEs' climate and economic impacts statewide, and projected them to 2020. Please visit CleanPowerExchange.org for these figures and a description of how we calculated them.

The Community Choice movement is in its infancy. We anticipate accelerated growth based on the powerful impacts we've already seen. However, it will be crucial for legislators and regulators to level the playing field for Community Choice. We must join forces to advocate for the lowest possible GHG emissions at the fairest price - with the greatest benefits for consumers, communities, and the climate. We look forward to collaborating with you in this important endeavor.

\$70 MILLION

Sonoma Clean Power has saved customers \$70 million since its inception.

100% GHG-FREE POWER

Silicon Valley Clean Energy serves 100% GHG-free power to all customers at launch.

10 MILLION WATTS

Lancaster Choice Energy recently broke ground on a 10 MW local solar project.

Community Choice Energy is underway in 28 counties and 300+ cities



A program of the Center for Climate Protection

CleanPowerExchange.org



- **See our interactive map** updated weekly with current information on Community Choice activity in all 58 counties and 482 cities in California
- **Access resources and tools** for emerging and operating Community Choice agencies
- **Continue the Business of Local Energy Symposium** by joining our webinar on Thursday, June 29, 12:00 – 1:00. Ben Foster, Fosterra Clean Energy Consulting, will describe our new study on the economic impact of local renewable power procured by Community Choice using San Joaquin Valley as a case study. Additionally, Ismael Herrera, incoming Director of the California Partnership for the San Joaquin Valley, will discuss the economic implications of accelerated solar deployment for San Joaquin Valley.
- **Sign up for our bi-weekly e-news** at CPX for comprehensive, current Community Choice news from all over the state of California



The mission of the Center for Climate Protection is to inspire, align, and mobilize action in response to the climate crisis. We work with business, government, youth and the broader community to advance practical, science-based solutions for significant greenhouse gas emission reductions.

We create model programs that reduce greenhouse gas emissions for communities everywhere. Our cost-effective energy solutions make it easier for everyone to do the right thing. We advance game-changing policies that dramatically shrink our carbon footprint for a positive future.
www.climateprotection.org



**Local
Government
Commission**

Leaders for Livable Communities

For over 35 years LGC has connected cutting-edge leaders from across the nation. Together we are advancing transformative policies and implementing innovative solutions for sustainable communities. LGC supports local policymakers through nationally recognized events, low-cost technical assistance and policy guidance on climate change, energy, water and community design.
www.lgc.org



Local
Government
SUSTAINABLE ENERGY
Coalition

The Local Government Sustainable Energy Coalition (LGSEC) enhances the role of local governments in California's sustainable energy future by providing a strong collective voice for its city, county and local agency members on sustainable energy policy decision-making in key regulatory agency proceedings. Since 2007, LGSEC has played a central role in developing local government programs including Community Choice Aggregation, Local Government Partnerships, and Regional Energy Networks.
www.lgsec.org

EverGreen

100% local, renewable electricity



Geothermal Turbine

Leading California to a Cleaner Tomorrow

EverGreen is Sonoma Clean Power's (SCP's) 100% renewable electricity service, made entirely locally.

When you choose EverGreen for your home or business, you are nearly eliminating greenhouse gas emissions from your electricity use. And best of all, geothermal is a baseload resource, which means it produces clean energy 24/7.

Join the movement to pioneer a clean energy future by choosing EverGreen

Clean Energy... Day and Night



Local. Renewable. Ours.

sonomacleanpower.org/evergreen
1 (855) 202-2139



"WE DO NOT INHERIT THE EARTH FROM OUR ANCESTORS; WE BORROW IT FROM OUR CHILDREN"

WENDELL BERRY, ENVIRONMENTAL ADVOCATE



SECURING AMERICA'S ENERGY FUTURE TODAY

Today's decisions will shape our country's future. At Shell we're exploring a broad mix of energies. As a global energy company, we're helping meet the world's growing demand for more energy in economically, environmentally and socially responsible ways. With a portfolio of wind, solar, biofuels and other clean energy sources, we've been working to increase the supply and use of renewable energy for years. And we're helping meet today's global energy demand by delivering natural gas, as a cleaner alternative to coal, to more countries than any other energy company.

Let's broaden the world's energy mix.

www.shell.com/makethefuture





BAY AREA
AIR QUALITY
MANAGEMENT
DISTRICT

Proud to present ***Spare the Air—Cool the Climate***
A clean air and climate protection strategy for the Bay Area
BAAQMD.gov

YOU CAN'T SAVE
WHAT YOU CAN'T SEE



If you want to make the most of your energy strategy, you need a clear view of where and when energy waste occurs. Direct Energy Business can help you see your operation like never before, and turn energy into an asset.



directenergybusiness.com

© 2017 DIRECT ENERGY. ALL RIGHTS RESERVED.

DEB-0168-2017



L.A. County is a proud sponsor of the Local Energy Symposium and invites cities to join the Los Angeles Clean Choice Energy program.

Learn more at sustainability.lacounty.gov

The Energy, Community Choice Aggregation and Regulatory Experts

EES Consulting provides economic, environmental, and engineering solutions for clients throughout the U.S. and Canada.

EES Consulting, Inc.

www.eesconsulting.com

- Strategic and Utility Financial Planning
- Rates and Cost of Service Studies
- Expert Witness and Litigation Support Services
- Integrated Resource Planning
- Conservation and Demand Response
- Merger and Acquisition Analysis
- Forecasting and Load Profiling
- Owner's Engineer Services
- Community Choice Aggregation and Operational Studies and Analysis
- Substation and Switchyard Planning, Cost Estimating, Engineering and Construction Management
- Control and Protection System Engineering
- Relaying Upgrades and Changeouts
- Smart Grid Infrastructure Engineering
- Equipment Condition Assessment and Capital Planning
- Hydroelectric Engineering
- Dam Safety Inspections and FERC Compliance
- Regulatory Compliance and Project Planning
- Environmental Project Management
- Mitigation Plan Development and Negotiation



KIRKLAND, WASHINGTON
570 Kirkland Way, #100
Kirkland, WA 98033
saleba@eesconsulting.com
Telephone: 425.889.2700
Facsimile: 425.889.2725

PORTLAND, OREGON
1455 NW Irving Street, #200
Portland, OR 97209
andersen@eesconsulting.com
Telephone: 503.223.5900
Facsimile: 503.827.8048

THANK YOU TO OUR PROMOTIONAL PARTNERS

Alliance of Regional Collaboratives for
Climate Adaptation

BayREN

California Center for Sustainable
Communities

California Green Business Program

Capital Region Climate Readiness
Collaborative

Center for Resource Solutions

Center for Sustainable Energy

CivicSpark

Clean Power Exchange

Climate Action Campaign

Community Environmental Council

Greenbiz

Green Cities California

Institute for Sustainable Infrastructure

Integrated Resources Network

LEAN

MCE Clean Energy

New Buildings Institute

Peninsula Clean Energy

Presidio Graduate School

Prospect Silicon Valley

Sacramento Area Council of Governments

San Diego Energy District

SLO Clean Energy

StopWaste

Ventura County Energy Choice

Western Riverside Council of Governments

Women's Environmental Network

Bravo to the community in Community Choice, especially to early heroes:

Paul Fenn
Hal Brown
Charles McGlashan
thank you
Carol Migden
Dawn Weisz
Rusty Klassen
Rebekah Collins
Shawn Marshall
Mark Leno
Bruce Wolf
Albert Vera
Megan Matson
Alden Feldon
Larry Chang
Renata Brillinger
Peter Luchetti
Skip Berg
Barbara George
Eric Brooks
David Orth
Kiki LaPorta
Cordel Stillman
Cynthia Wooten
Gerry Braun
Abby Young
Tom Ammiano
Lori Grace
Linda Jackson
Michael Dietrick
Lew Tremaine
Leslie Alden
Al Weinrub
Ross Mirkarimi
Robert Freehling

We know there are many more than shown.

HYATT REGENCY LONG BEACH

FIRST FLOOR

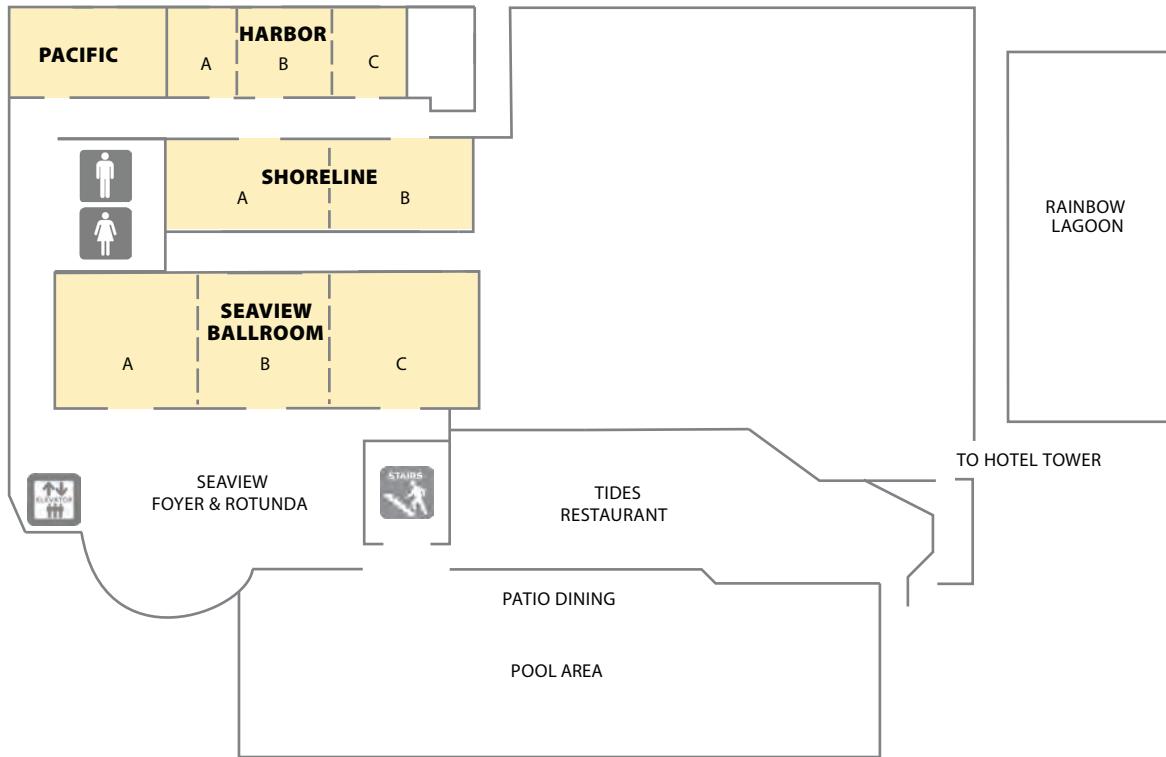

FOURTH FLOOR

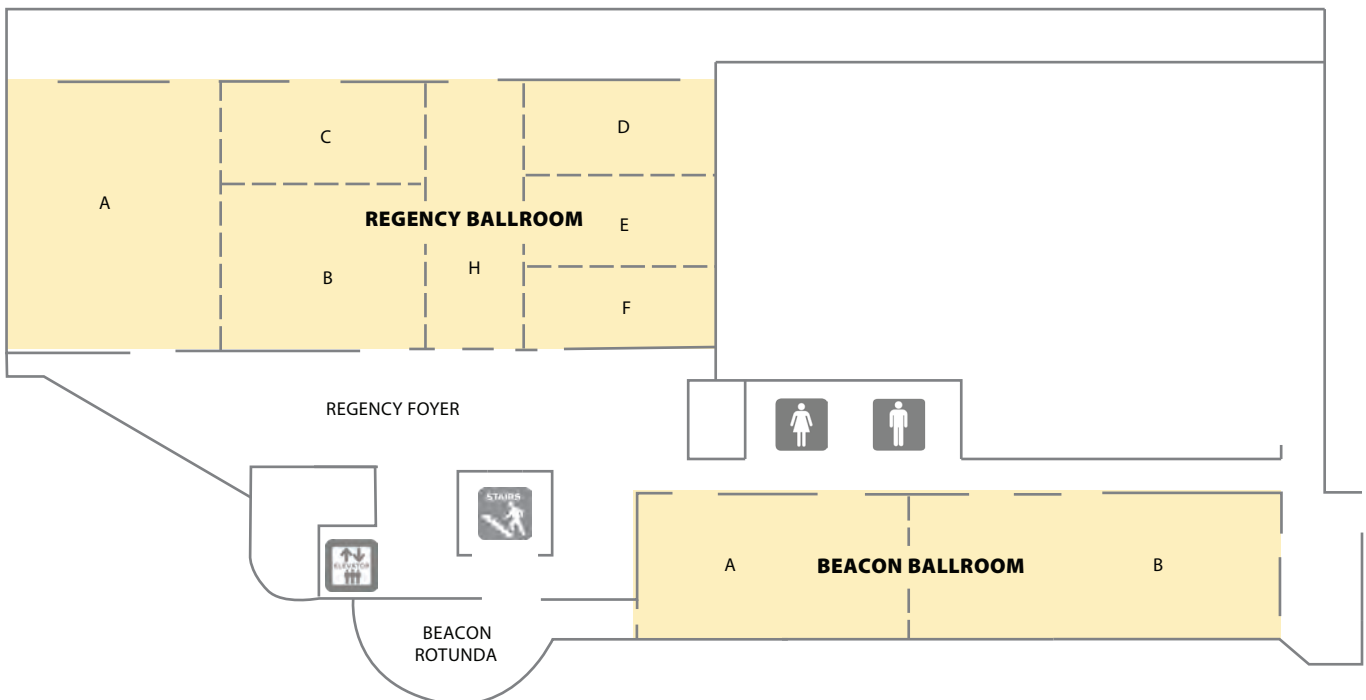

THANK YOU TO OUR SPONSORS

LEADERS



INNOVATORS



CHAMPIONS



ENTREPRENEURS



SUPPORTERS

MEDIA SPONSORS

